



Cloak 400 Sconce

INLITE Lighting New Zealand

Wall Light

Cloak is defined by its clean profile and considered detailing. Refined fixings are thoughtfully resolved, while textured glass lends depth and tactility to the form.

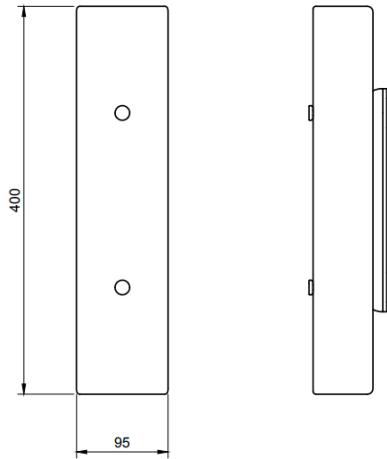
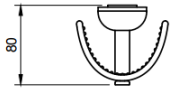

Dims: 95mm W x 400mm H x 80mm D
Weight: 1kg

Features

Mounting	Wall Surface Mounted
IP Rating	IP65
Shade	Glass
Frame	Aluminium Powder Coated
Control Gear	Remote Driver, Dali or Phase

Technical

Wattage	3.6W
Colour Temperature	2700K (3000K Available)
CRI	CRI>90+
Lumens	500lm
Lifetime	50,000 hours
Warranty	3 Years